

# SE Ytterdörrsats

Utan låshus

Matt krom/Krom

Dörrhandtag

Cylinder med härdade borskyddade stift

**Innehåll:**

Dörrhandtag

Cylinder med 3 nycklar

Cylindervred

Cylinderring 1 st 13 mm och 1 st 16 mm

Skruvats

## Habo Ytterdörrsats- Monteringsanvisning

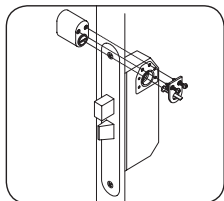

**Bild 1**

Skruva fast cylindern och cylindervredpinnen från dörrens insida.

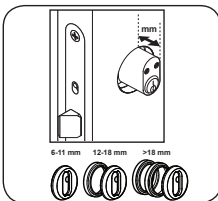

**Bild 2**

Om cylindern sticker ut 6-11 mm från dörrbladet monteras endast cylinderringen. Cylinderring + förhöjningsring monteras då låscylindern sticker ut 12-18 mm från dörrbladet. Vid längre utstick kompletteras monteraget med en Cylinderring Universal Extra artikel: 16813 krom alternativ 16814 matt krom.

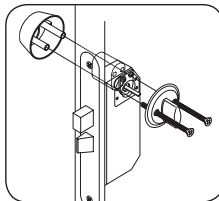

**Bild 3**

Siruva fast cylindervred och cylinderring. Skruvarna kapas efter behov, se instruktioner vid bild 2.

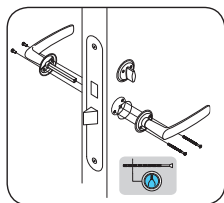

**Bild 4**

Beroende på dörrens tjocklek kapas skruvarna i önskad längd, skruva fast dörrhandtaget. Observera att längden på skruven skall vara så att den inte dras i botten mot hylsmuttern för ett så stabilt montage som möjligt.



**OBS!**

Passar till dörrtjocklek 30-70 mm.

Extranycklar och cylindrar går att beställa hos din lokala låssmed.

Kontakta ditt försäkringsbolag om vilka särskilda krav på låsning som gäller för ditt hem.

**Dörrhandtag**

A640



A2560



Atlanta

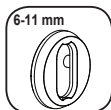
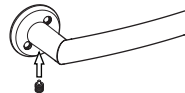

Cylinderring

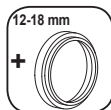

Cylinderring



Cylindervred

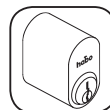

Cylinder

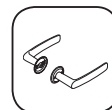

Handtag

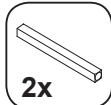

Roddarpinne

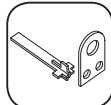

Cylindervredpinne

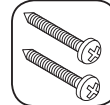

Cylinderskruv



Nyckel



Hylsmutter och skruv

## NO Ytterdørsett

Uten låskasse  
Matt krom/Krom

### Dørvrider

Sylinder med herdede borebeskyttede stifter

### Innhold:

Dørvrider  
Sylinder med 3 nøkler  
Knappvrider  
Sylinderskilt 1 stk. 6-11 mm  
Forhøyningsring 1 stk. 12-18 mm  
Skruesett

## Habo Ytterdørsett - Monteringsanvisning

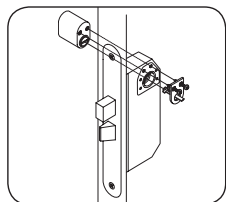

Bilde 1

Skru fast sylinderen og medbringeren fra dørens innside.

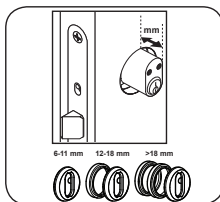

Bilde 2

Kun sylinderskiltet monteres hvis sylinderen stikker ut 6-11 mm fra dørbladet. Sylinderskilt og medfølgende forhøyningsring monteres hvis sylinderen stikker ut 12-18 mm fra dørbladet. Ved lengere utstikk kompletteres monteringen med en forhøyningsring Universal Ekstra i tillegg.

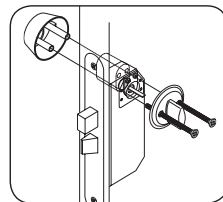

Bilde 3

Skru fast knappvrideren og sylinderskiltet. Skruene kappes etter behov. Se instruksjoner ved bilde 2.

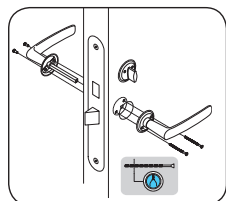

Bilde 4

Avhengig av dørens tykkelse kappes skruene i ønsket lengde, skru deretter fast dørvrideren. Lengden på skruene tilpasses slik at de ikke skrues i bunn av hylsemutteren, for at monteringen skal være så stabil som mulig.



### NB!

Passer til dørtykkelse på 30-70 mm.

Ekstra nøkler og sylinder kan bestilles hos din lokale låsesmed og i de fleste byggevareforretninger.

Kontakt forsikrings-selskapet ditt for hvilke særskilte krav som stilles til avlåsning av ditt hjem.

### Dørvrider

A640



A2560



Atlanta

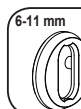
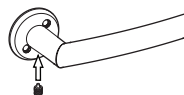

Sylinderskilt

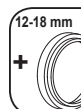

Forhøyningsring



Knappvrider

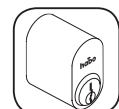

Sylinder



Dørvrider

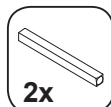

2x  
Vriderpinne

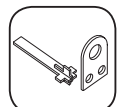

Medbringer

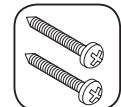

Sylinderskruer



3x  
Nøkkel



2x  
Hylsemutter og skruer

## DK Dørgrebssæt

Uden låsekasse  
Mat krom/Krom

### Dørgreb

Cylinder med hærdede borebeskyttede stifter

### Innhold:

Dørgreb  
Cylinder med 3 nøgler  
Cylindervrider  
Cylinderring 1 stk. 6-11 mm  
Forhøyningsring 1 stk. 12-18 mm  
Skruesæt

## Habo Dørgrebssæt- Monteringsvejledning

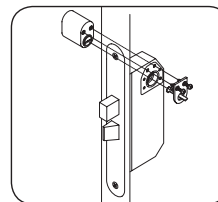

Billede 1

Skru cylinderen og medbringeren fast fra dørens indvendige side. Benyt de korte skruer (2 stk).

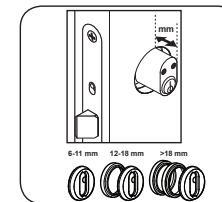

Billede 2

Hvis cylinderen stikker 6-11 mm ud fra dørbladet, monteres kun cylinderringen. Cylinderring + forhøyningsring monteres, når cylinderen stikker 12-18 mm ud fra dørbladet. Ved længere udstik suppleres monteringen med cylinderring universal extra artikel.

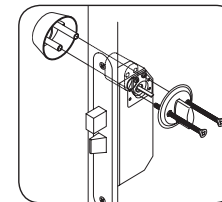

Billede 3

Skru cylindervrideren og cylinderring fast. Skruene afkortes efter behov.

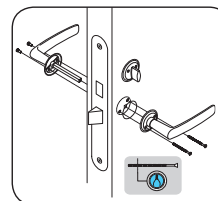

Billede 4

Afkort skruerne, så de passer til dørens tykkelse. Bemærk, at længden på skruen tilpasses, så den ikke skrues i bund mod hylstermøtrikken, for at få en så stabil montering som muligt.



### Bemærk!

Passer til dørtykkelse 30-70 mm.

Ekstra nøgler og cylinder kan bestilles hos din lokale låsesmed og byggecentre.

Kontakt dit forsikrings-selskab om hvilke krav de har til sikring af dit hjem.

### Dørgreb

A640



A2560



Atlanta

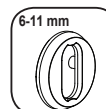
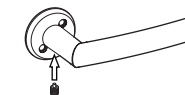

Cylinderring

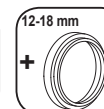

Forhøyningsring



Cylindervrider

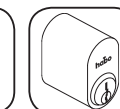

Cylinder

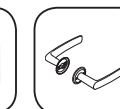

Dørgreb

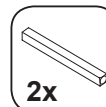

2x  
Dørgrebspind

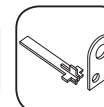

Medbringer

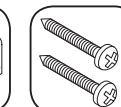

Cylinderskruer

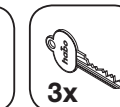

3x  
Nøgle

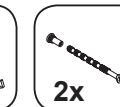

2x  
Hylstermøtrik og skruer

## FI Ulko-ovisarja

Ilman lukkopesää

Mattakromi/Kromi

Painike

Sylinteri karkaistulla poraussuojatulla tapilla

### Pakkauksen sisältö:

Painike

Sylinteri ja 3 avainta

Sylinteriväännin

Sylinterirenkaat 1 kpl 6-11 mm

Korotusrengas 1 kpl 12-18 mm

Ruuvisarja

## Habo Ulko-ovisarja – Asennusohje

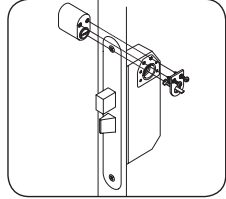

**Kuva 1**

Ruuvaa sylinteri ja sylinterivääntimen tappi kiinni oven sisäpuolelta.

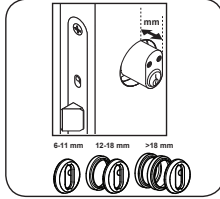

**Kuva 2**

Jos lukkosylinteri ulkonee oville 6-11 mm, käytetään asennuksessa vain sylinterirenkasta. Jos sylinteri ulkonee oville 12-18 mm, käytetään sylinterirenkasta ja korotusringasta. Jos sylinterin ulkonee vielä suurempi, käytetään asennuksessa sylinterirenkasta, jota on saatavilla lisäosana.

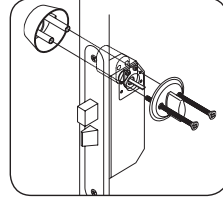

**Kuva 3**

Ruuvaa sylinteriväännin ja sylinterirenkas kiinni. Lyhennä ruuveja tarpeen mukaan, ks. kuvan 2 ohje.

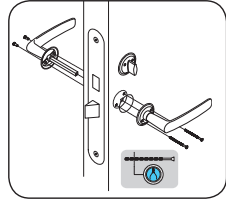

**Kuva 4**

Katkaise painikkeen ruuvit sopivan pituisiksi oven paksuuden mukaan ja ruuvaa painike paikalleen. Ruuvien tulee olla sen pituiset, etteivät ne kierry hylsymutterin pohjaan. Näin varmistat että asennuksesta tulee mahdollisimman tukeva.



**Huomaa!**

Sopii 30 – 70 mm:n paksuisiin oviin.

Lisäävaimia ja sylinterejä voit tilata paikalliselta lukkosepältä.

Selvitä omalta vakuutusyhtiöltäsi, asettavatko vakuutusehtosi jotain erityisvaatimuksia kotisi lukitukselle.

### Painike

A640



A2560



Atlanta

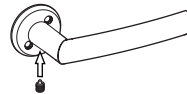

Sylinterirenkas

Korotusrengas

Sylinteriväännin

Sylinteri

Painike

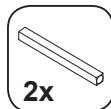

Neliötappi

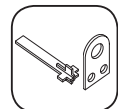

Sylinterivääntimen tappi

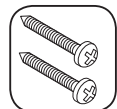

Sylinteriruuvi



Avain



Hylsymutteri ja ruuvi

## GB Outer door set

Without lock case

Matt chrome/Chrome

Door handle

Cylinder with hardened, drill-protected pin

### Contents:

Door handle

Cylinder with 3 keys

Thumbturn

Cylinder rings 1 pcs 6-11 mm

Spacer ring 1 x 12-18 mm

Screw set

## Habo Outer door set - Assembly instructions

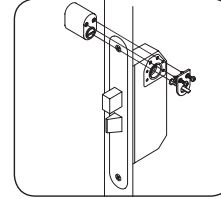

**Illustration 1**

Tighten the cylinder and thumbturn pin from the inside of the door.

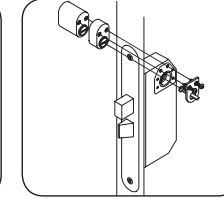

**Illustration 2**

If the cylinder protrudes by 6-11 mm from the door leaf, only fit the cylinder ring. Fit cylinder ring + spacer ring when the lock cylinder protrudes 12-18 mm from the door leaf. If it protrudes any further, the installation should be supplemented with a Universal cylinder ring extra item.

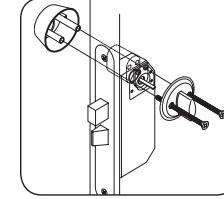

**Illustration 3**

Tighten the thumbturn and cylinder ring. Cut the screws as necessary, see instructions illustration 2.

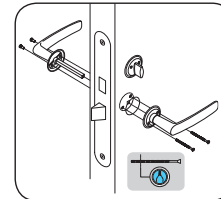

**Illustration 4**

Depending on the thickness of the door, cut the screws to the required length, tighten the door handle. Note that the length of the screws must be such that they are fully tightened in relation to the barrel nut, to ensure as stable mounting as possible.



**NB!**

Fits door thickness 30-70 mm.

Spare keys and cylinders can be ordered at your local locksmith.

Contact your insurance company regarding which specific requirements apply for locks in your home.

### Door handle

A640



A2560



Atlanta

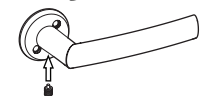

Cylinder ring

Spacer ring

Thumbturn

Cylinder

Handle

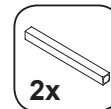

Carrier pin

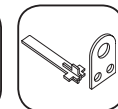

Thumbturn pin

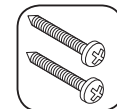

Cylinder screw



Key



Barrel nut and screw